

# Triple Eccentric Metal Seated Butterfly Valves

## CLASS 150LB WAFER TYPE

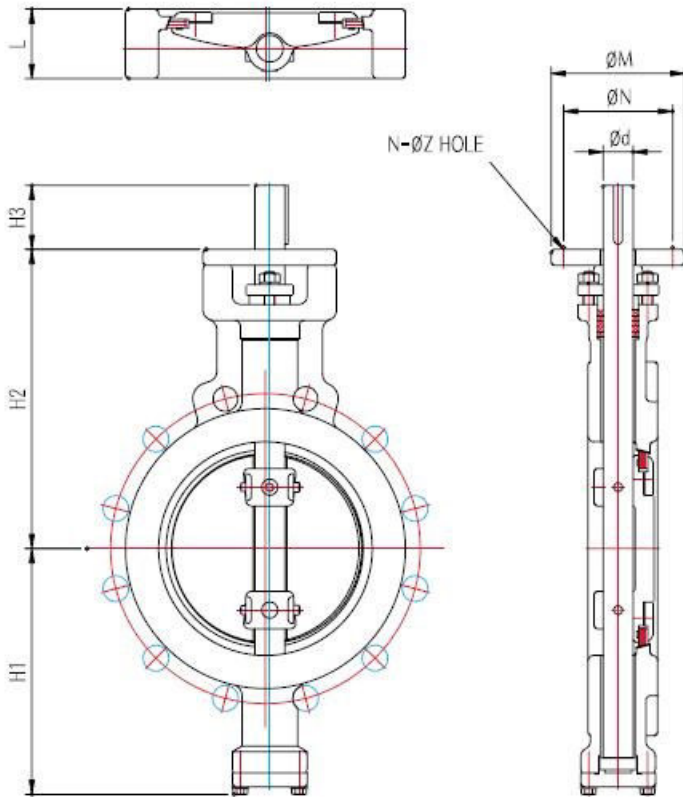

## CLASS 150LB LUG TYPE

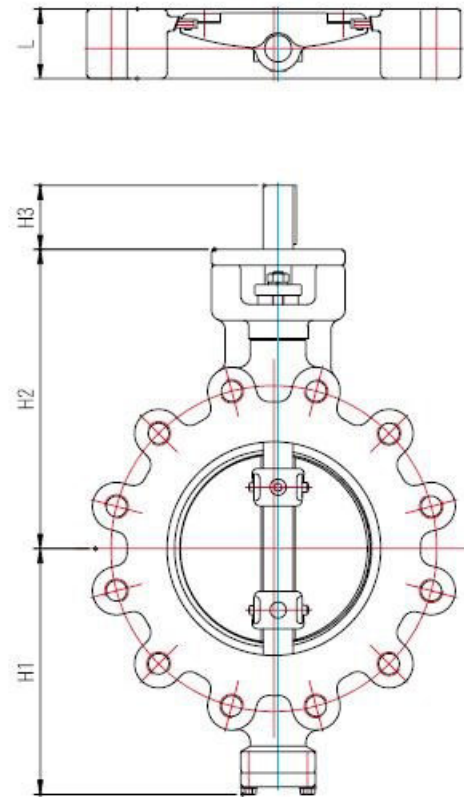

### VALVE DIMENSIONS

unit : mm

SIZE			L	H1	H2	STEM		TOP FLANGE			
WAFER (inch)	LUG (inch)	mm				KEY		TYPE	ØN	ØM	N - ØZ
						H3	Ød				
2"	2"	50	43	116	170	45	12	F07	70	90	4 - 9
2.5"	2.5"	65	46	129	177	45	12	F07	70	90	4 - 9
3"	3"	80	48	141	185	45	19	F07	70	90	4 - 9
4"	4"	100	54	161	200	45	19	F07	70	90	4 - 9
5"	5"	125	57	187	217	45	22	F07	70	90	4 - 9
6"	6"	150	57	203	240	45	22	F07	70	90	4 - 9
8"	8"	200	64	230	280	60	25	F10	102	125	4 - 12
10"	10"	250	71	270	320	60	32	F10	102	125	4 - 12
12"	12"	300	81	308	360	75	40	F14	140	175	4 - 18
14"	14"	350	92	340	390	75	40	F14	140	175	4 - 18
16"	16"	400	102	381	445	75	45	F14	140	175	4 - 18
18"	18"	450	114	407	490	100	50	F16	165	210	4 - 22
20"	20"	500	127	444	500	100	55	F16	165	210	4 - 22
22"	22"	550	154	484	530	100	65	F25	254	300	8 - 18
24"	24"	600	154	509	570	100	65	F25	254	300	8 - 18
	26"	650	210	545	645	120	85	F30	298	350	8 - 23
	28"	700	229	570	651	120	95	F30	298	350	8 - 23
	30"	750	230	600	684	120	100	F30	298	350	8 - 23
	32"	800	241	645	740	120	110	F30	298	350	8 - 23
	36"	900	241	699	769	150	120	F35	356	415	8 - 33
	40"	1000	300	770	870	150	140	F35	356	415	8 - 33
	44"	1100	350	835	930	150	160	F40	406	475	8 - 39
	48"	1200	350	898	995	220	180	F48	483	560	12 - 39

※ The flange dimension shall be conformed to ANSI 150LB, KS/JIS 5K/10K/16K, BS PN6/PN10/PN16, DIN PN6/PN10/PN16, ISO PN6/PN10/PN16 respectively.